

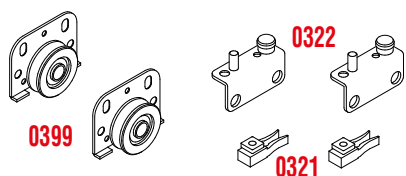



## KIT 0322-399 - MAX 40 KG



### Legenda KIT / Kit Legend

<b>0399</b>	Carrello inferiore <i>Lower truck</i>
<b>0321</b>	Fermo superiore per profilo Art. 0320 <i>Upper stopper for profile Art. 0320</i>
<b>0322</b>	Guida superiore DX-SX <i>Right-left upper runner</i>

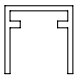
### Legenda altri componenti Legend other items

<b>0320</b>		Profilo alluminio superiore <i>Upper aluminium profile</i>
<b>0380</b>		Profilo alluminio inferiore <i>Lower aluminium profile</i>
<b>0300</b>		Profilo alluminio inferiore <i>Lower aluminium profile</i>

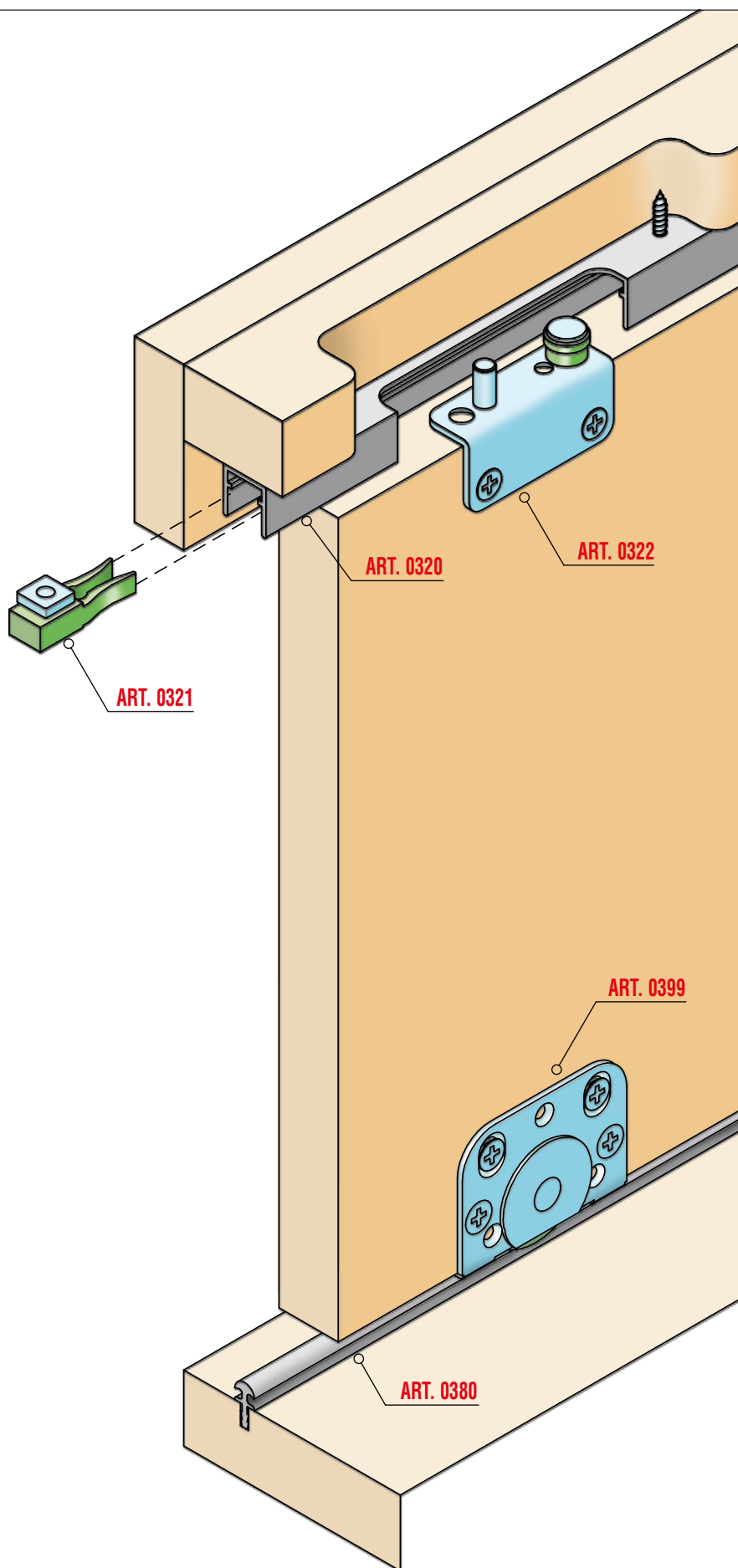



Sistemi scorrevoli per mobili / Sliding systems for furniture

## Sezione verticale / Vertical section

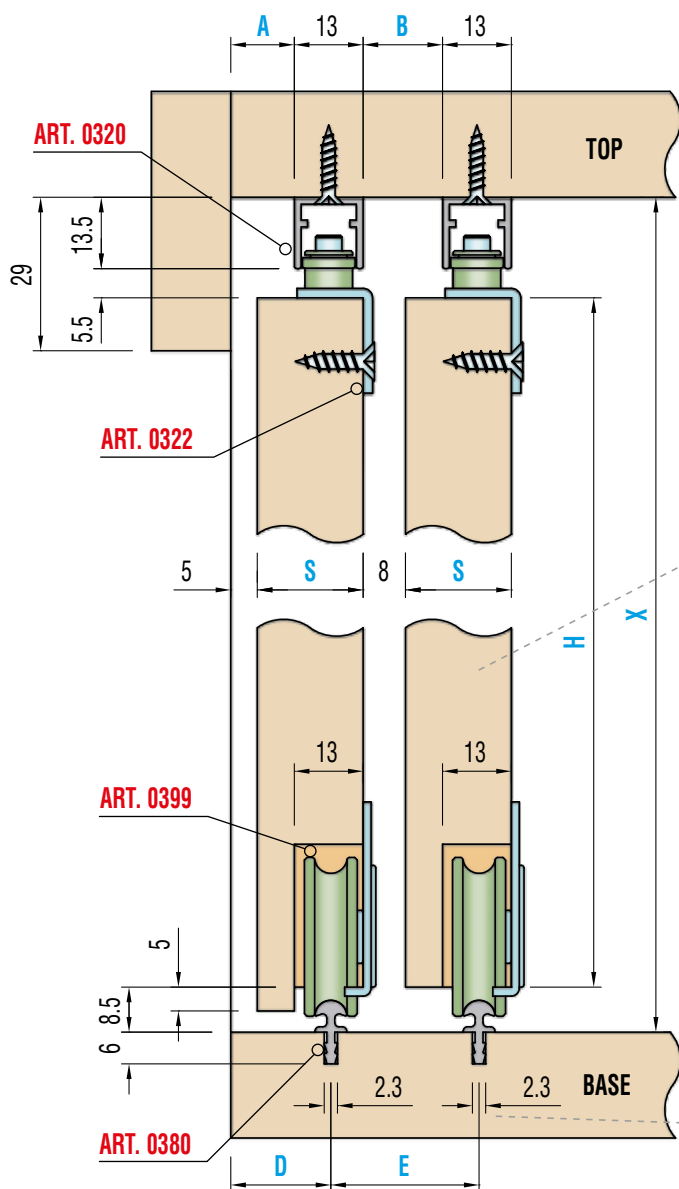

Peso massimo anta Kg. 40  
Maximum door weight Kg 40

A =	S* -8
B =	S* -5
C =	S* -1
D =	S* +8
H =	X -27,5

S\* (spessore / thickness)  
min.16

### Variante Special version

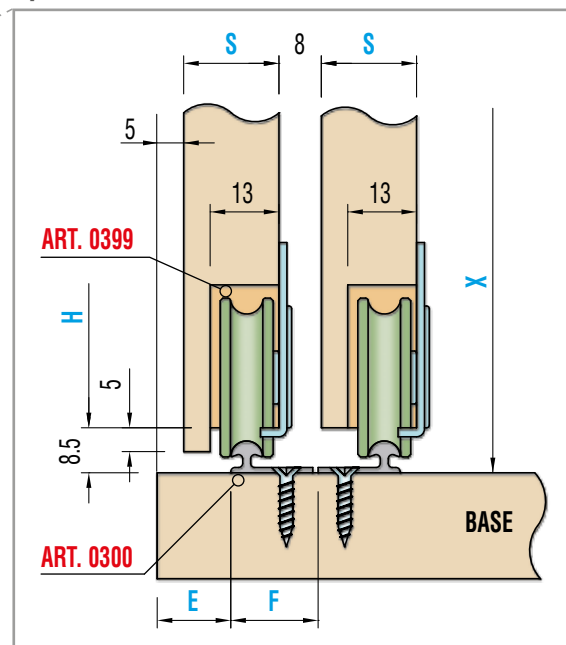

E =	S* -4
F =	S* -1,5
H =	X -27,5

## Schema Foratura ante / Doors drilling

